

PCTS_ALLE

08.12.2016

Illuminated tactile contact block, momentary



General Data

Type reference	PCTS(L)_R0
Description	Contact block for base-plate mounting
Approvals	CCC, CE, cURus, ENEC10, VDE, UKCA
Contact type	1 inverter
Degree of protection	IP00
Operation travel	2.3 mm
Connection type	PCB-mount terminals
Contact material	gold-plated 1.5µm
Max. storage temperature	-40°C ... 80°C
Max. operating temperature	-25°C ... 70°C
Mechanical life	1 million switching cycles
Electrical life (rated load)	1 million switching cycles at rated load
Contact resistance NO	< 50 mOhm (new state)
Contact resistance NC	< 100 mOhm (new state)
Bouncing time NO	< 10ms
Bouncing time NC	< 10ms

Technical Data - Lamp

Lamp socket	none, with integrated 3 mm LED
Max. lamp voltage	30 V AC/DC (*1)
Definition	X1 ...anode, X2...cathode

Electrical features

Rated voltage	20 mV ... 48 V AC/DC
Rated current	0.01 mA ... 100 mA

Note

1 inverter (snap-action contact)
R0= LED without series resistor



The contact unit is being snapped into neck of the pushbutton/switch head.
Spacer sleeves ensure the correct distance between PCB and mounting plate.

Instruction for mounting

The position offset between actuator and switching element must lie in a circle of $\varnothing 0.2\text{mm}$.

(*1) does not apply to the types "..._R0"

UL approval for: PCTS(L)(xV)(_R0)

Data acc. to UL508

Rating

20mV...48 V AC/DC, 0.01mA...100 mA , max. 250 mW

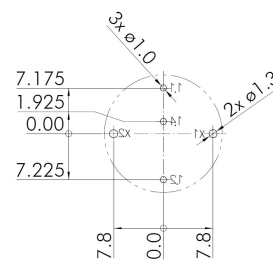
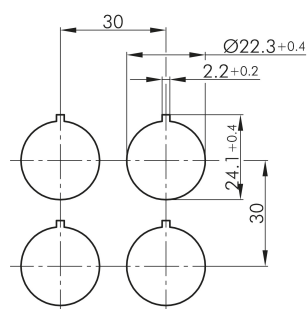
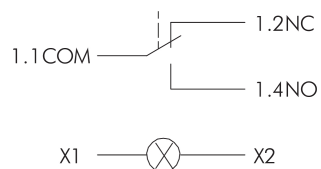

Sicht auf Bestückungsseite
der Leiterplatte

