

# Datasheet

## → RRJSSA23

02/15/2026



### Technical data

Key actuator, momentary

Type	RRJSSA23
Series	Rontron-R-Juwel
Rubric	Key-operated switch
Approvals	CCC, CE, cURus, UKCA



### → General data

Design	Round
Operating temperature	-25 °C ... 70 °C
Panel cut-out	Ø 22.3 mm
Front bezel colour	Silver-coloured
Storage temperature	-50 °C ... 85 °C
Degree of protection front	IP65

### → Electrical data

Enclosure type	Type 4x indoor
----------------	----------------

### → Mechanical data

Tightening torque fixing nut	max. 1.5 Nm
Mounting position	Any
Mounting plate thickness	1.5 mm ... 5 mm

Switching function

Momentary function

Switching position

-45° momentary  
0° key removable  
45° momentary

**Note**

- Includes 2 keys
- Different locking possible on request

**Technical drawings**

→ Dimensional drawing

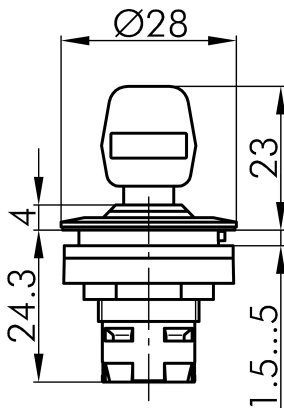

→ Cutout dimensions

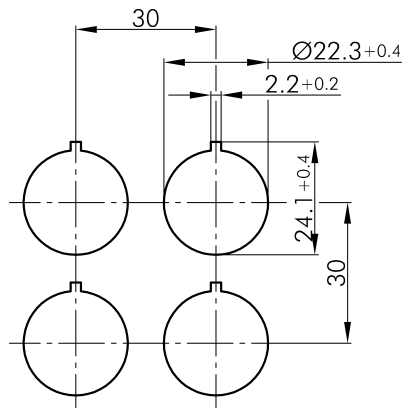

→ Position indicator

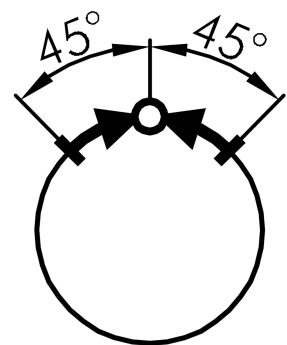

**Awards**

