

Datasheet

→ RQJSSA31

02/15/2026



Technical data

Key actuator, maintained (3 different keys)

Type	RQJSSA31
Series	RONTRON-Q-JUWEL
Rubric	Key-operated switch
Approvals	CCC, cCSAus, CE, cULus, UKCA



→ General data

Design	Rounded square
Operating temperature	-25 °C ... 70 °C
Panel cut-out	Ø 22.3 mm
Front bezel colour	Silver-coloured
Storage temperature	-50 °C ... 85 °C
Degree of protection front	IP65

→ Electrical data

Enclosure type information acc. to UL	Type 4x indoor
--	----------------

→ Mechanical data

Tightening torque fixing nut	max. 1.5 Nm
Mounting position	Any
Mounting plate thickness	1.5 mm ... 5 mm

Switching function

Latching function

Switching position

-90° maintained
0° key removable
90° maintained

Note

- Includes 2 keys
- Different locking possible on request

Technical drawings

→ Dimensional drawing

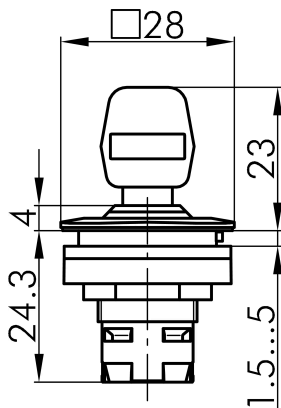

→ Cutout dimensions

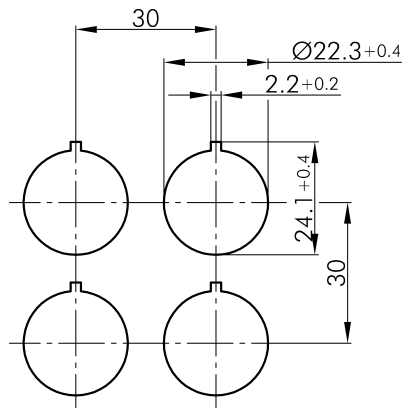

→ Position indicator

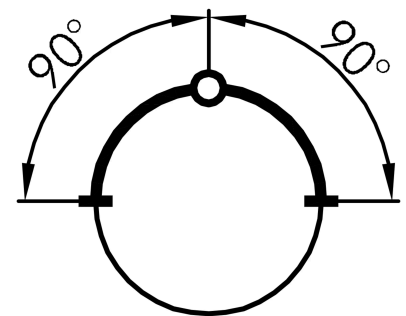

Awards



DESIGNPREIS
2007
NOMINIERT



product
design
award
2006