

# Datasheet

→ **FRTPOI** 

05/05/2026



## Technical data

Push-button contact blocks with print connections

Type	FRTPOI
Series	contact blocks FRTP...
Rubric	Contact blocks
Approvals	CCC, CE, cURus, ENEC10, VDE, TÜV_Süd, UKCA



## → General data

Design	Round
Illumination	Yes
Operating temperature	-25 °C ... 70 °C
Enclosure colour	Grey
Contact material	AgNi
Storage temperature	-40 °C ... 80 °C
Degree of protection front	IP00

## → Electrical data

Conditional short circuit current	1000 A
Rated operating voltage IEC/EN 60947-5-1	240 V AC 120 V AC 250 V DC 125 V DC 60 V DC 24 V DC

Rated operating current IEC/EN 60947-5-1	1.5 A AC 3 A AC 0.27 A DC 0.55 A DC 1 A DC 2 A DC
Rated insulation voltage IEC/EN 60947-5-1	250 V AC 250 V DC
Rated voltage	250 V AC/DC
Rated impulse withstand voltage	2.5 kV
Rated current	6(4) A
Contact resistance	< 20 mΩ NO new state < 20 mΩ NC new state
Electrical lifetime	600,000 switching cycles at rated voltage
Utilisation category IEC/EN 60947-5-1	AC-15 B300 DC-13 Q300
Contact type	1NC 1NO
Short circuit protection SCPD	6 A Char. D
Illuminant	LED optionally retrofittable
Bouncing time	< 10 ms NC < 10 ms NO
Rating information acc. to UL	Pilot duty B300 24 V DC Pilot duty B300 3 A DC
Switching capacity	240 V AC/DC 1.5 A 120 V AC/DC 3 A
Breaking capacity IEC/EN 60947-5-1	10 I <sub>e</sub> AC 1.1 I <sub>e</sub> DC
Minimum voltage	5 V
Current minimal	1 mA under laboratory conditions
Thermal continuous current IEC/EN 60947-5-1	5 A AC

**Note**

- For lighting with LED: overvoltage category II (2.5 kV), pollution degree 2
- 100,000 switching cycles (at max. switching capacity)

➔ **Mechanical data**

<i>Connection</i>	PCB-mount terminals
<i>Operating travel</i>	2.3 mm
<i>Mechanical lifetime</i>	600,000 switching cycles
<i>Switching function</i>	Momentary function
<i>Positive opening</i>	Acc. to EN60947-5-1, appendix K

**Note**

- The contact elements must not be used individually. There must always be at least 2 contact elements on the circuit board, each of which must be arranged offset by 180°.

**Note Service life with emergency stop**

- 30.000 (RKUV28, RRJUV)
- 6050 (RXJUV)

**Note for use with key switches**

- When mounting the contact element on a key switch, ensure that the anti-twist protection is correctly aligned with the larger circuit.

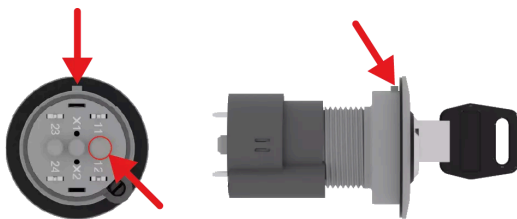

— ODER/OR —

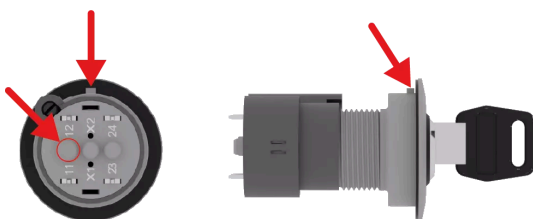

## Technical drawings

→ Dimensional drawing

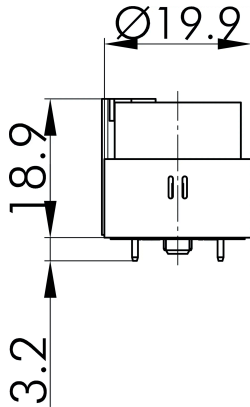

→ Cutout dimensions

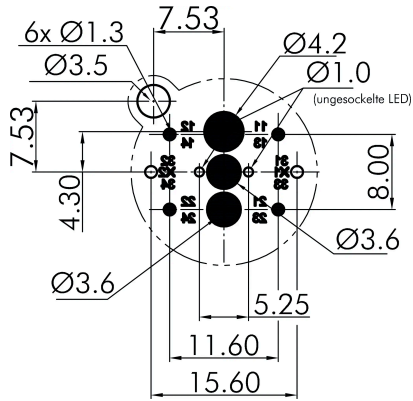

→ Circuit diagram

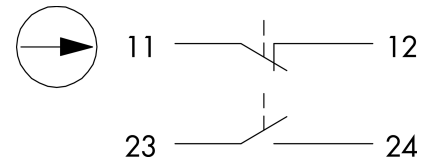

→ Switching path diagram

