

**PCTS\_ALLE**

08.12.2016

**Tactile contact block, momentary**

**General Data**

Type reference	PCTS(L)(_R0)
Description	Contact block for base-plate mounting
Approvals	CCC, CE, cURus, ENEC10, VDE, UKCA
Contact type	1 inverter
Degree of protection	IP00
Operation travel	2.3 mm
Connection type	PCB-mount terminals
Contact material	gold-plated 1.5µm
Max. storage temperature	-40°C ... 80°C
Max. operating temperature	-25°C ... 70°C
Mechanical life	1 million switching cycles
Electrical life (rated load)	1 million switching cycles at rated load
Contact resistance NO	< 50 mOhm (new state)
Contact resistance NC	< 100 mOhm (new state)
Bouncing time NO	< 10ms
Bouncing time NC	< 10ms

**Technical Data - Lamp**

Lamp socket	none, with integrated 3 mm LED
Max. lamp voltage	30 V AC/DC (*1)
Definition	X1 ...anode, X2...cathode

**Electrical features**

Rated voltage	20 mV ... 48 V AC/DC
Rated current	0.01 mA ... 100 mA

**Note**

1 inverter (snap-action contact)  
R0= LED without series resistor



The contact unit is being snapped into neck of the pushbutton/switch head.  
Spacer sleeves ensure the correct distance between PCB and mounting plate.

#### Instruction for mounting

The position offset between actuator and switching element must lie in a circle of  $\varnothing 0.2\text{mm}$ .

(\*1) does not apply to the types "...\_R0"

UL approval for: PCTS(L)(xV)(\_R0)

### Data acc. to UL508

Rating

20mV...48 V AC/DC, 0.01mA...100 mA , max. 250 mW

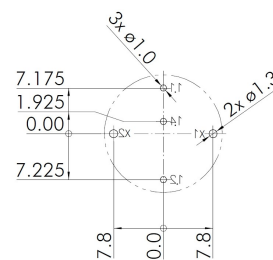
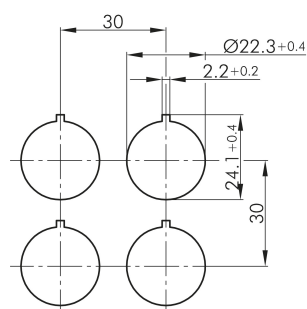
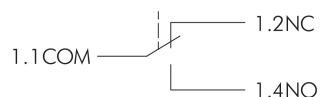

Sicht auf Bestückungsseite  
der Leiterplatte

