

Datasheet

→ **MKTI** 

04/15/2026



Technical data

Push-button contact element

Type	MKTI
Series	contact blocks MK...
Rubric	Modular contact block
Approvals	CE, UKCA, cULus

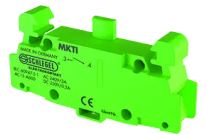

→ General data

Operating temperature	-40 °C ... 70 °C
Flammability class UL94	V0
Enclosure colour	Green
Weight	8.8 g
Contact material	AgNi
Storage temperature	-50 °C ... 85 °C
Material	PA66
Degree of protection front	IP20

→ Electrical data

Stripping length	9 mm
Conditional short circuit current	1000 A

Rated operating voltage IEC/EN 60947-5-1	240 V AC 480 V AC 250 V DC 125 V DC 60 V DC 24 V DC
Rated operating current IEC/EN 60947-5-1	3 A AC 1.5 A AC 0.2 A DC 0.4 A DC 1 A DC 2 A DC
Rated insulation voltage IEC/EN 60947-5-1	600 V AC 600 V DC
Rated impulse withstand voltage	6 kV
Rated impulse withstand voltage IEC 60947-5-1, UL/CSA 60947-5-1	6 kV
Contact resistance	< 30 mΩ NO
Electrical lifetime	1,000,000 switching cycles at 240 V / 3 A (AC15) 50,000 switching cycles at 480 V / 1.5 A (AC15) 1,000,000 switching cycles at 250 V / 0.2 A (DC13) 200,000 switching cycles at 24 V / 3 A (DC13)
Utilisation category IEC/EN 60947-5-1	AC-15 A600 DC-13 Q600
Contact type	1NO
Short circuit protection SCPD	16 A char. C
Conductor cross section	1 x 0.5 mm ² - 2 x 2.5 mm ²
Bouncing time	< 10 ms NO
Rating IEC 60947-5-1, UL/CSA 60947-5-1	Heavy pilot duty A600 600 V / 1.2 A Heavy pilot duty Q600 24 V / 2 A
Rating UL-CB IEC 60947-1/5-1/5-5	600 V / 1.2 A Thermal current 16 A 24 V / 2 A AC-15 480 V / 1.5 A AC-15 240 V / 3 A DC-13 250 V / 0.2 A DC-13 24 V / 2 A
Switching capacity	240 V AC/DC 3 A 24 V DC 2 A

Breaking capacity IEC/EN 60947-5-1	10 I _e AC 1.1 I _e DC
---------------------------------------	---

Minimum voltage	5 V
-----------------	-----

Current minimal	1 mA under laboratory conditions
-----------------	----------------------------------

Thermal continuous current IEC/EN 60947-5-1	16 A AC
--	---------

Thermal continuous current IEC 60947-5-1, UL/CSA 60947-5-1	16 A
---	------

Overvoltage category	III
----------------------	-----

Pollution degree	3
------------------	---

Note on PELV/SELV

- If modules are used in a SELV (PELV) circuit and other circuits at the same time, the maximum permissible voltage U_e/U_i is limited to 300AC in accordance with EN 60947-1.

→ Mechanical data

Connection	Screw connection Torx/slotted
------------	-------------------------------

Operating travel	4 mm
------------------	------

Tightening torque connection	0.8 Nm ... 1 Nm
------------------------------	-----------------

Mechanical lifetime	> 1,000,000 switching cycles max. 50,000 switching cycles emergency-stop
---------------------	---

Switching function	Momentary function
--------------------	--------------------

Technical drawings

→ Dimensional drawing

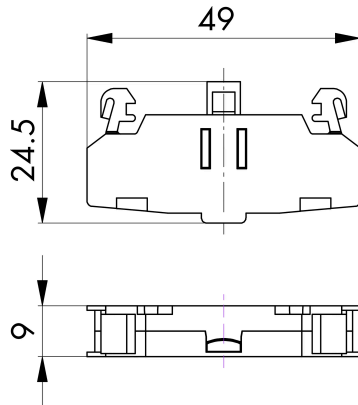

→ Circuit diagram

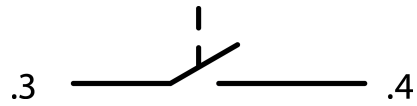

→ Switching path diagram

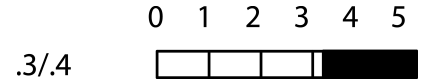

Awards



Focus Open 2022
Silver

