



### General Data

|                               |  |
|-------------------------------|--|
| Type reference:               | CT...  |
| Approvals:                    | CCC, cCSAus, CE, cURus, DNVGL  |
| Protection class:             | II (protective insulation)   |
| Operation travel:             | 3 mm   |
| Connection type:              | Faston terminals 2.8x0.8 mm  |
| Contact material:             | gold-plated 1.5µm  |
| Max. storage temperature:     | -50°C ... 85°C   |
| Max. operating temperature:   | -30°C ... 70°C, without illumination<br>-30°C ... 55°C, using incandescent lamps<br>-30°C ... 65°C, using LEDs |
| Mechanical life:              | 1 million switching cycles   |
| Electrical life (rated load): | 1 million operations at rated load   |
| Contact resistance NO:        | < 50 mOhm (new state)  |
| Contact resistance NC:        | < 100 mOhm (new state)   |
| Bouncing time NO:             | < 10ms   |
| Bouncing time NC:             | < 10ms   |

### Technical Data - Lamp

|                     |                          |
|---------------------|--------------------------|
| Lamp socket:        | T5,5K                    |
| Max. lamp voltage:  | 60V                      |
| Max. lamp output:   | 1.2W                     |
| Definition:         | X1...anode, X2...cathode |
| Electrical features |                          |
| Rated voltage:      | 20mV ... 48V AC/DC       |
| Rated current:      | 0.01mA ... 100mA         |

### Note

Faston terminals 2.8x0.8mm are not suitable for manual soldering.

### Electrical data acc. to IEC/EN 60947-5-1 (VDE 0660 Sect. 200)

|                              | alternate current | direct current |
|------------------------------|-------------------|----------------|
| Utilisation category:        | AC12              | DC12           |
| Rated insulation voltage Ui: | 60V               | 60V            |
| Rated operating voltage Ue:  | 48V               | 48V            |
| Rated operating current Ie:  | 0.1A              | 0.1A           |
| Continuous thermal current:  | 100mA             | 100mA          |

### Note

GB14048.5-2008 (IEC60947-5-1)

### Electrical data acc. to C22.2 No. 14-10

|                |                    |
|----------------|--------------------|
| Rated voltage: | 20mV ... 48V AC/DC |
| Rated current: | 0.01mA ... 100mA   |

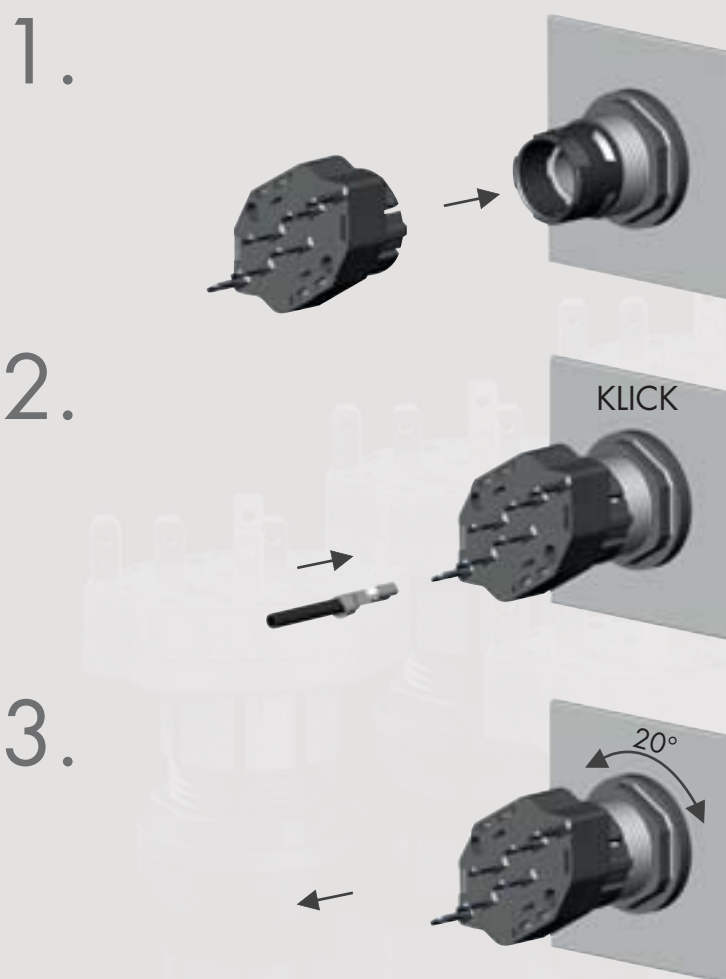

| Illustration | Description | Type |
|--------------|-------------|------|
|--------------|-------------|------|

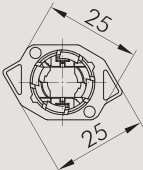

IP00  
3mm

**Contact block, momentary**  
**2 inverters**

Faston terminals 2.8x0.8 mm  
suitable plug-in socket CAP6

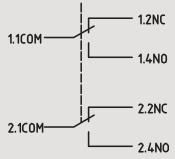





suitable pushbuttons and switches:



Contact material: gold-plated 1.5µm **CT2**

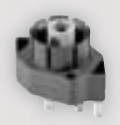
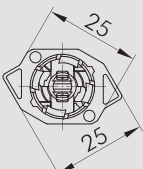

IP00  
3mm

**Illuminated contact block, momentary**  
**2 inverters**

Faston terminals 2.8x0.8 mm  
suitable plug-in socket CAP8  
Lamp socket T5,5K

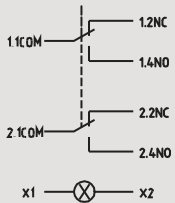





suitable pushbuttons and switches:



Contact material: gold-plated 1.5µm **CTL2**

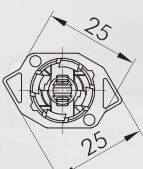

IP00  
3mm

**Contact block with two-piece plunger, momentary**  
**2 inverters**

Faston terminals 2.8x0.8 mm  
two galvanically isolated inverters  
suitable plug-in socket CAP6

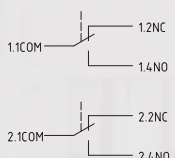





suitable pushbuttons and switches:



Contact material: gold-plated 1.5µm **CT2\_549**

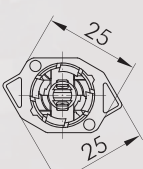

IP00  
3mm

**Illuminated contact block with separate plungers, momentary**  
**2 inverters**

Faston terminals 2.8x0.8 mm  
two galvanically isolated inverters  
suitable plug-in socket CAP8  
Lamp socket T5,5K

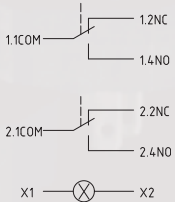

suitable pushbuttons and switches:

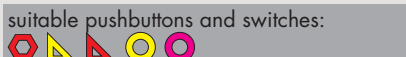

Contact material: gold-plated 1.5µm **CTL2\_549**

# Contact blocks CT...

flat-plug connections

MADE IN GERMANY



Illustration

Description

Type

## Accessories

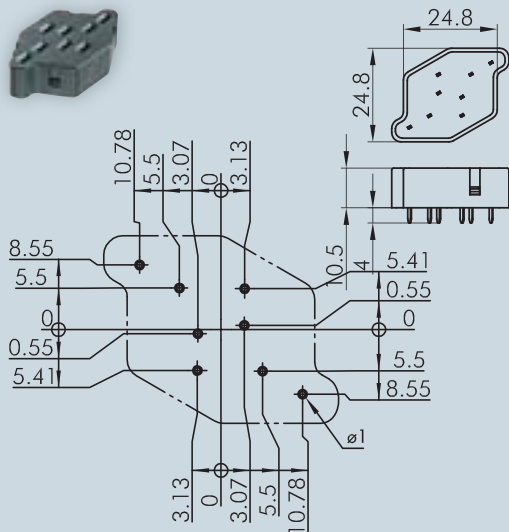

### Plug-in socket with 8 contacts

for CTL2, CTL2\_549

Connection type: PCB-mount terminals

CAP8

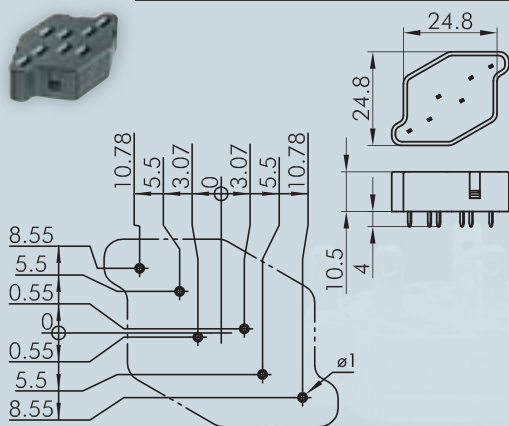

### Plug-in socket with 6 contacts

for CT2, CT2\_549

Connection type: PCB-mount terminals

CAP6



### Insulating case

for Faston clamp FH2,8, slip on from the front

IH2,8



### Faston clamp 2.8 x 0.8 mm with snap-in pin

cross section 0.75 - 1.50 mm<sup>2</sup>, tin-plated brass, with pin to snapfit into the sockets XA, XAL and the insulating case IH2.8

FH2,8



### Double Faston

for the connection of 2 Faston clamps FH2.8

FD2,8

About Us

Busbars/Switches

Panel Mount Jacks

Emergency-Stop Buttons

Bus Technology

RFD

Enclosures

Pedal Switches

Terminal Blocks

Type Index

Illustration

Description

Type



**Ultra-bright LED, T5,5K socket, 12V**  
with integrated series resistor and half-wave rectifier, for 12 V AC/DC (7/14 mA)  
when connecting to DC, the correct polarity must be observed:  
+ ... X1/- ... X2  
storage temperature:  
-25°C ... +80°C  
ambient temperature:  
-20°C ... +60°C  
voltage tolerance:  
+ 10 %

Colour: white L5,5K12UW



**Ultra-bright LED, T5,5K socket, 24V**  
with integrated series resistor and half-wave rectifier, for 24 V AC/DC (7/14 mA)  
when connecting to DC, the correct polarity must be observed:  
+ ... X1/- ... X2  
storage temperature:  
-25°C ... +80°C  
ambient temperature:  
-20°C ... +60°C  
voltage tolerance:  
+ 10 %

Colour: white L5,5K24UW

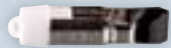

**Two-colour LED, T5,5K socket - 24V**  
mit eingebautem Vorwiderstand  
Farbe abhängig von der Polarität  
Lagertemperatur:  
-25°C ... +80°C  
Umgebungstemperatur:  
-20°C ... +60°C  
Spannungstoleranz:  
+ 10 %

|                        |      |      |
|------------------------|------|------|
| Farbe:                 | rot  | grün |
| Nennstrom [mA]:        | 14   | 13   |
| Lichtstärken [mcd]:    | 2300 | 650  |
| Dom. Wellenlänge [nm]: | 625  | 525  |

Colour: red/green L5,5K24RG



**Ultra-bright LED**  
ready-made for CTP\_485  
Connection type solder pins, grid 2.54 mm

Colour: white LED3UW



**LED adapter**  
for LEDs of 3 and 5 mm Ø to be used in T5.5K sockets  
an external resistor must be provided

suitable contact blocks:



LA5,5